

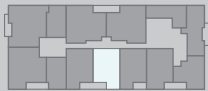

AUSTIN  
THE RESIDENCES

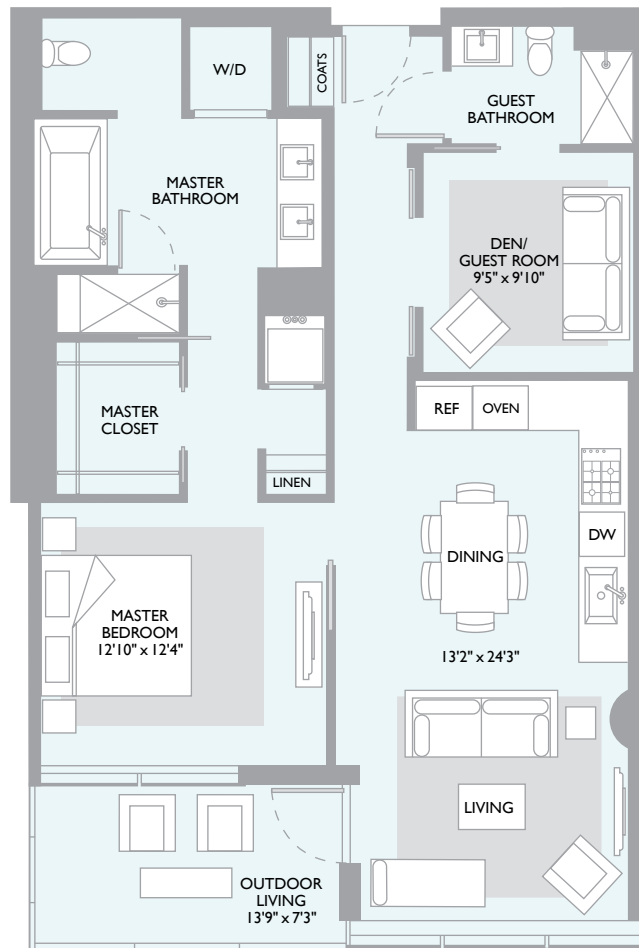

## W RESIDENCE 1F

1169 SF / 1068 SF Interior / 101 SF Balcony / 1 Bedroom / 2 Bathrooms / Den  
South Side

EXPLORE [WAUSTINRESIDENCES.COM](http://WAUSTINRESIDENCES.COM) OR 512.322.9221

A CJUF II STRATUS BLOCK 21 LLC PROJECT. THE RESIDENCES AT W AUSTIN ARE NOT OWNED, DEVELOPED OR SOLD BY STARWOOD HOTELS & RESORTS WORLDWIDE, INC., CJUF II STRATUS BLOCK 21 LLC OR THEIR AFFILIATES. CJUF II STRATUS BLOCK 21 LLC USES THE W® TRADEMARKS AND TRADE NAMES UNDER A LICENSE FROM STARWOOD HOTELS & RESORTS WORLDWIDE, INC. STARWOOD HOTELS & RESORTS WORLDWIDE, INC. AND THEIR AFFILIATES ARE NOT RESPONSIBLE FOR THE CONTENT PRESENTED IN THIS WEB SITE, INCLUDING BUT NOT LIMITED TO, ANY ADVERTISING CLAIMS, MARKETING PRACTICES, AND DATA COLLECTION, USE AND PRIVACY PRACTICES.



# W RESIDENCE IF

## RESIDENCE FEATURES

- South Exposures
- Floor-to-Ceiling Ultra High-Efficiency, High Visibility Window System
- Living Area with Ceiling Height of Approximately 10'6"
- Imported European Wide-Plank Wood Floors Treated with Natural Oil, throughout Living Areas
- Architectural Ceiling Coves along Glazed Perimeters for Window Treatments, including Electrical Conduits for Mechanized Shades (Window Treatments not Included)
- Architectural Coves for Wall and Ceiling with Indirect Lighting
- Glass Panel and Stainless Steel Railing on Balcony
- Coat Closet

## KITCHEN AND DINING

- Fully Integrated Bulthaup® Kitchen with Dark Grey Aluminum or Black Brown Oak Cabinet Fronts
- Dual Spray Pullout Kitchen Faucet in Polished Chrome
- Imported European Wide-Plank Wood Floor Treated with Natural Oil
- Miele® Refrigerator and Freezer with Integrated Panel to Match Cabinetry
- Miele® Stainless Steel Gas Cooktop
- Miele® 30" Master Chef Oven
- Miele® 24" Stainless Steel Speed Oven
- Miele® Stainless Steel Ventilation Hood System
- Miele® Dishwasher with Integrated Panel to Match Cabinetry
- Stainless Steel Undermount Kitchen Sink
- Garbage Disposal System
- Predetermined Selection of Carrara Marble or Limestone Countertops

## LIVING

- Floor-to-Ceiling Windows: South Views
- Imported European Wide-Plank Wood Floor Treated with Natural Oil
- Access to Outdoor Living Room

## DEN

- Dual Sliding Entry Doors
- Pocket Door with Access to Guest Bath

## MASTER BEDROOM

- Windows with Views to the South
- 100% Wool Luxury Carpet Putty Colored

## MASTER BATHROOM

- Bathroom Floors, Vanity Tops and Walls in Limestone or Carrara Marble
- Double Vanity Area with Above-Counter Duravit® Wash Basins designed by Philippe Starck
- Duravit® Tub Designed by Philippe Starck
- Dornbracht® Lavatory Faucets
- Dornbracht® Tub Faucet
- Dornbracht® Shower System
- Kohler® Water Conserving Dual-Flush Toilet
- Pocket Door

## GUEST BATHROOM

- Bathroom Floors, Vanity Tops and Walls in Limestone or Carrara Marble
- Above-Counter Wash Basin
- Dornbracht® Lavatory Faucet
- Kohler® Shower System
- Kohler® Water Conserving Dual-Flush Toilet